

White's Electronics, Inc.

1011 PLEASANT VALLEY ROAD

SWEET HOME, OREGON 97386

OPERATORS INSTRUCTIONS



Manufacturers of The World's Largest Line of Mineral and Metal Detectors

MINERAL AND METAL
DETECTORS

ELECTRONIC
MAGNETOMETERS

SUPER GEIGER AND
SCINTILLATION COUNTERS

ULTRA VIOLET
LIGHTS

SPECIAL NOTICE

" Do not raise the loop higher than the instrument or water may run down inside of the rod and damage the electronic components."

SPECIAL NOTICE

Caution: When lifting the instrument lid to replace your battery, be careful not to let the loop cable "double back" on itself. Such an action may possibly cause a short in the cable shield. A short of this nature is characterized by a constant "loud hum" over which the Tuner knob has no effect.

ASSEMBLY AND OPERATING INSTRUCTIONS
FOR
WHITE'S BEACHCOMBER TR-S METAL DETECTOR

Also for the Coingetter

WHITE'S ELECTRONICS, INC.

1011 Pleasant Valley Road
Sweet Home, Oregon 97386

ASSEMBLY AND OPERATING INSTRUCTIONS
FOR
WHITE'S BEACHCOMBER TR-S METAL DETECTOR

Congratulations! You are now the proud owner of one of the world's finest metal detectors. You'll enjoy the many exciting and relaxing hours you spend with your new detector.

Before you start out, however, read the following instructions carefully. Practice as often as you can. Soon your detector and you will make an almost "unbeatable" team.

ASSEMBLY INSTRUCTIONS

1. Remove your new detector from the shipping package. Note that the rod section is in two pieces.
2. Align the two rod ends and insert the lower section into the upper section until it stops.

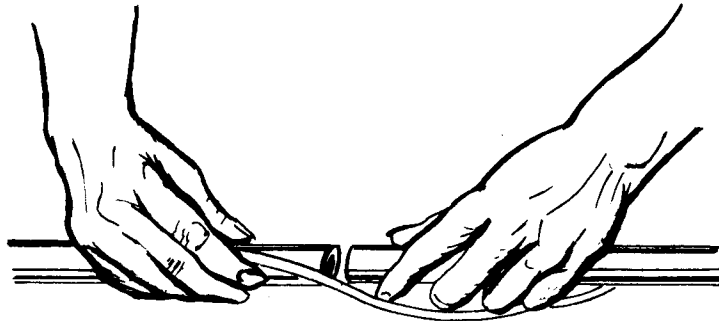

3. Now, wrap the loop cable around the rod. This is done by simply rotating the lower rod section two or three complete turns. Do not, however, wrap the loop cable too tightly!

4. Next, depress the spring-loaded studs at the end of the lower rod section and push the lower section gently into the upper section until the desired pair of matching holes in both sections is lined up. The spring will then automatically force the studs through the holes, locking the two sections together.
5. Finally, adjust the angle of the search loop and check the tightness of the loop mounting thumbnut. It should be finger-tight. If it is too tight, the loop will not adjust to various angles. If it is too loose, the loop may not stay in position.

HOW TO TUNE YOUR DETECTOR

Your new detector will help you locate buried metal objects. Gold, silver and copper coins, brass, lead and platinum are all metals.

Tuning your instrument properly is extremely important. Read the following instructions carefully and practice them until you can tune your instrument without looking at this manual.

One more thing: Always tune your instrument out-of-doors. That way you won't get unwanted interference from metal objects used in the construction of your home.

Follow these steps to tune your detector:

1. While standing, raise the loop slightly (about 1/2-inch) off the ground and hold it as steady as you can.
2. Now, turn the Tuner Knob to the right (clockwise) until you hear a loud tone coming from the speaker. Readjust this same knob to the left (counter-clockwise) until the tone almost goes away completely.
3. Lower the loop flat on the ground. The tone should decrease in volume or disappear completely. You are now ready to begin searching.

NOTE: If you are searching in an area of rough terrain (a plowed field for example), it may not be possible to search with your loop flat on the ground. In such cases, you should search with the loop just barely off the ground, after tuning your instrument with the loop slightly above the level at which you intend to search. It is important to note here that if the loop is raised above the height at which the detector was tuned, a loud tone may be emitted from the speaker. Yet, if the instrument is tuned with the loop higher than necessary, this may result in unneeded loss of detection depth. In both instances, these reactions will interfere with your ability to locate buried objects.

LISTEN FOR THE TONE

The tone coming from the speaker of your detector will tell you where objects are located. When you hear a sharp bleep, or an increase in the volume of the tone, the loop is over an object. When the volume decreases, or goes away completely, the loop has passed away from an object. Generally, the volume will be loudest when the center of the loop is directly over an object. An exception to this rule, however, is a coin buried on edge. In this case, the volume will be loudest when the edge of the loop passes over the coin, thus causing a double sound when detected.

SEARCHING WITH YOUR DETECTOR

To locate hidden or buried objects with a properly tuned detector, systematically sweep the loop from side to side across the area you are working. The larger the diameter of your loop, the more area you can cover in a single sweep and the faster you can search an area. For example, with an eight-inch loop you should take four-inch steps, moving the loop ahead the same amount after each sweep. For maximum performance when searching, you should always try to keep the loop at a constant level and as close to the ground as possible, following the tuning instructions described earlier in this manual.

All in all, the depth to which your instrument will detect may depend on a number of factors: 1) The degree of mineralization in the ground. The less mineralization, the deeper it will detect. 2) The height of the loop during tuning and searching. The lower the loop, the deeper it will detect. And, 3) How carefully your detector is tuned. The more accurate the tuning, the deeper it will detect.

WHAT WILL YOUR INSTRUMENT DETECT?

Silver, lead, copper, bottle caps, tinfoil, gold, cartridge cases, rings, aluminum foil, brass and tin cans are some of the highly conductive metal objects that will cause a response in your speaker, headphones or earplug. Your instrument, however, will not detect sticks, rags, bones, paper, wood or other non-metallic objects.

The longer many metal objects have been buried, the better you may be able to detect them. A chemical reaction between such objects as silver or copper coins and the surrounding soil often creates a "halo" effect. This "halo" may cause your detector to register a much larger increase in volume than might otherwise be expected for a small coin. The "halo" can actually help you detect better. In fact, if the "halo" is strong enough, your instrument may continue to register even after you have dug up the coin!

PROPER CARE OF YOUR DETECTOR

1. **CLEANING:** Both the loop and rod are waterproof and can be cleaned with fresh water and a mild cleanser. After cleaning, dry the instrument thoroughly. Caution! Never raise the wet loop above the level of the instrument case. The instrument case is not waterproof and water may run down the rod into the case, damaging the electronic components.
2. **WEATHER CONDITIONS:** Protect your detector from excessively cold weather. Freezing can damage the electronic components, the case and/or the battery. Excessive heat can also damage the instrument. Never leave it in the sun. It's best to lay it in the shade when temporarily not in use. If it's left in a car on a hot day, cover it with a blanket or something similar to protect it from the direct rays of the sun and then leave the windows slightly open to permit ventilation. Needless to say, protect your instrument if you operate it in the rain, as water may get into the instrument case.
3. **SALT WATER:** Salt water is very corrosive! After your detector has been exposed to salt water, rinse it thoroughly in fresh water, being careful not to let the loop rise higher than the level of the instrument case. Then wipe it with a cloth dampened with fresh water and dry it thoroughly.
4. **STORAGE:** If you plan to store your instrument for any length of time, unsnap the battery pack, remove it from the instrument and take the battery out of the holder. Whenever your instrument is not in use, turn the Power knob all the way to the left until it clicks off.

BATTERIES

The battery is the lifeblood of your detector. Your instrument is powered by one 9-volt transistor battery. This type is available at drug and grocery stores everywhere. Any brand of battery will work well, although the alkaline energizer will probably last longer.

Generally speaking, your battery needs replacing when the volume becomes weak and the instrument loses sensitivity.

Prolonged use of your detector will cause a severe drain on your battery. It's best to turn the power off from time to time during a day of "shooting." This gives you a chance to take a break and it gives the battery a rest. In a few minutes both you and your battery will be ready to go again.

If you plan to store your detector for several weeks or more, it would be wise to keep the battery in the refrigerator. Doing so will prolong its life. Also, it's a good idea to carry an extra battery with you on outings.

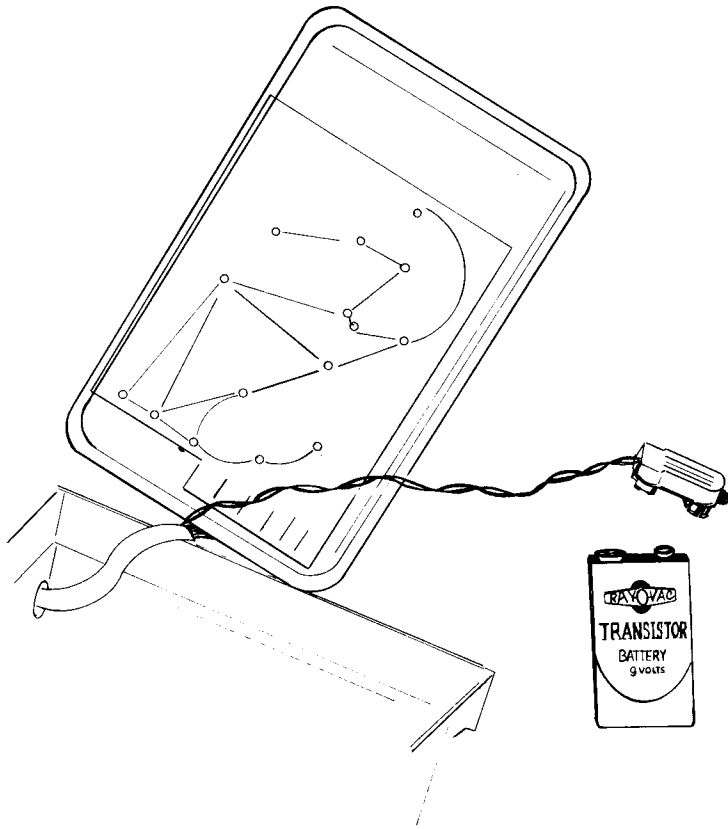

To change the battery, simply remove the front plate of the instrument control case. This is done by gently pulling the front plate forward. Lift the battery out of its compartment and unsnap the old battery. (Illustration)

Now snap the new battery into place, insuring the snaps are properly aligned. Replace the battery inside the case and reposition the front plate again.

SOME THOUGHTS ON ETHICS

Treasure hunting is the kind of new hobby that fires the imagination and generates its own enthusiasm. It's the most natural thing in the world to dig as fast as you can the minute you hear that first loud, unmistakable signal. It will be a real thrill to discover what treasure is right beneath your feet.

But stop a minute! Be a little far-sighted and consider the long-run, too.

We strongly urge you to adopt a code of ethics which will preserve the environment and also the rights of treasure hunters to operate detectors with as few restrictions as possible.

Before you even begin a search, check the law, ordinance or regulations about hunting on publicly owned sites. Abide by the rules. If the area is private property, get written permission from the owner to search it. You may find he will be more eager to give permission if you suggest sharing your finds with him, or if you offer to search for a specific item he has lost.

About digging: in lawn areas use a screwdriver of no more than six or eight inches as your tool. Limit the size of the hole to a maximum of two

inches in diameter, cutting a plug of sod which can be easily replaced after you make your find and fill the hole. Leaving holes is both unsightly and dangerous!

Detectors or detector modes designed for locating large and deeply buried objects should be used with discretion--never in lawn areas, and with careful judgment in other locations. Consider the scar you may leave by your digging before you start. This will vary a lot from one part of the country to another, depending on local soil and climatic conditions.

Public officials and private property owners will be much more likely to allow continued treasure hunting if you do no environmental damage. You may even be able to increase your reputation as an ethical hunter by volunteering to carry out and dispose of whatever trash items you find.

Adoption of these attitudes can only enhance the public's opinion of treasure hunters and assure that many areas, both public and private, remain open to you and your new detector.

SERVICE AND WARRANTY INFORMATION

If your metal detector is ever in need of service, ship it to us at the factory address below or to one of our Service Centers listed on the back of the warranty statement. Insure it fully, prepay the charges and enclose a letter describing the nature of the problem. We'll correct the matter and return the instrument as soon as possible. As long as your instrument is under warranty there is no charge other than a small handling and postage fee.

Read your warranty card carefully. It describes completely what is covered and the length of the coverage. If you have any questions, don't hesitate to write to us. We will be happy to answer any questions you may have.



1011 Pleasant Valley Rd.
Sweet Home, Or. 97386