



METAL DETECTOR

TR/Hipmount

**MODEL NO.
321.596360**

- assembly
- control description
 - trouble shooting
- operating procedures
 - maintenance

OWNER'S MANUAL

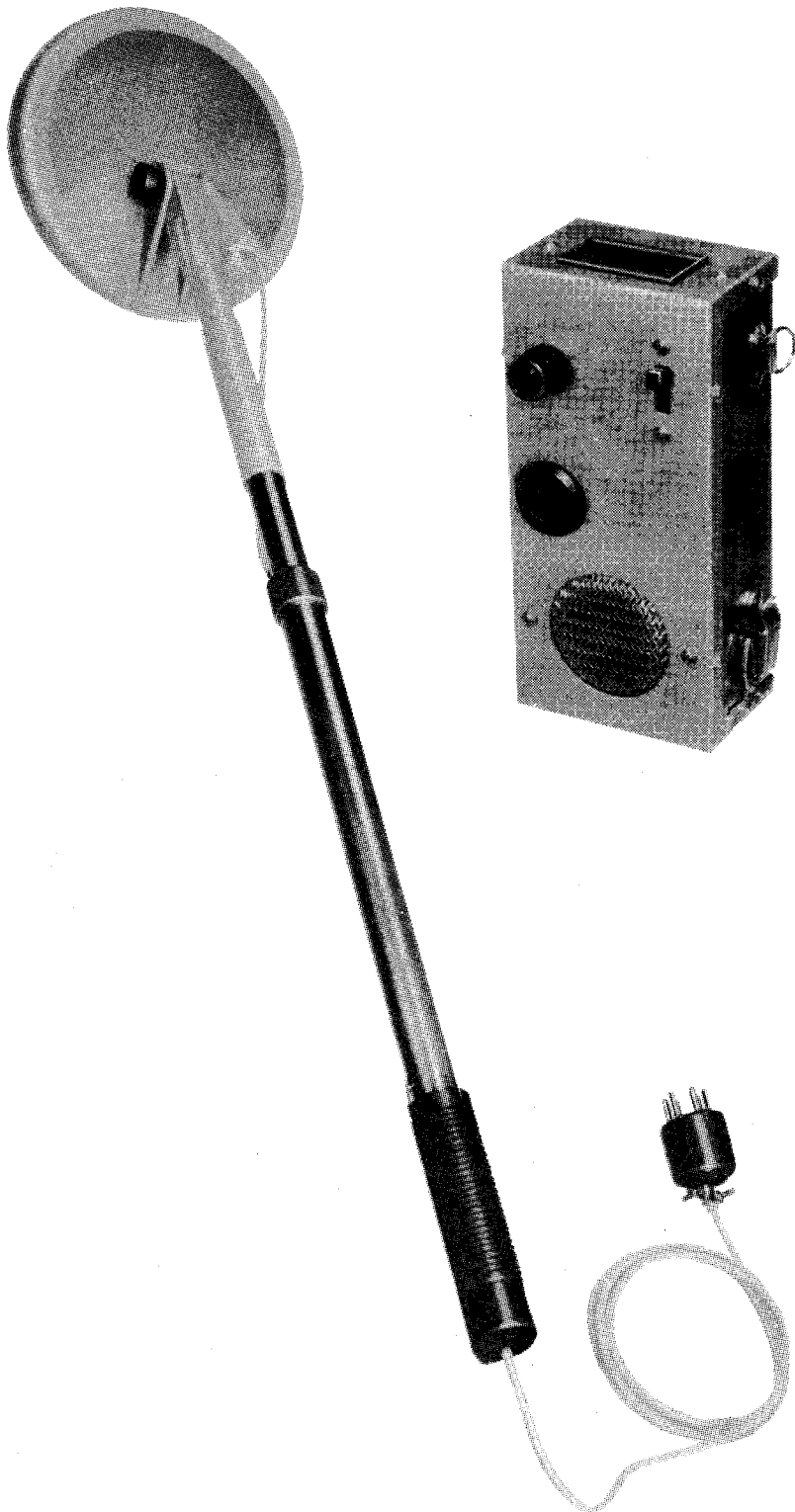

Illustrated Parts Listing

ASSEMBLY PARTS

Key No.	Part No.	Part Name
1	501-4002	Cover, Loop 6"
2	801-3139	Probe, MM
3	528-0047	Screw, Brass
4	501-0010	Washer, T.P.R.
5	402-0004	Thumbnut, No. 516
6	501-2008	Clevis, Isolator
7	500-0096	Ring, Fibre Compression
8	500-0114	Clip, Stainless, Belt
9	520-0042	Plug, Loop 6 Pin
10	523-0012	Holder, Battery 9V Long
11	520-0017	Connector, Battery 9V Black
12	500-0090	Grille, Speaker MM
13	402-0019	Knob
14	802-0001	Case, MM with Battery Compartment
15	521-0003	Strap, Carrying
16	400-0022	Meter
17	500-0100	Spring, Latch 1B

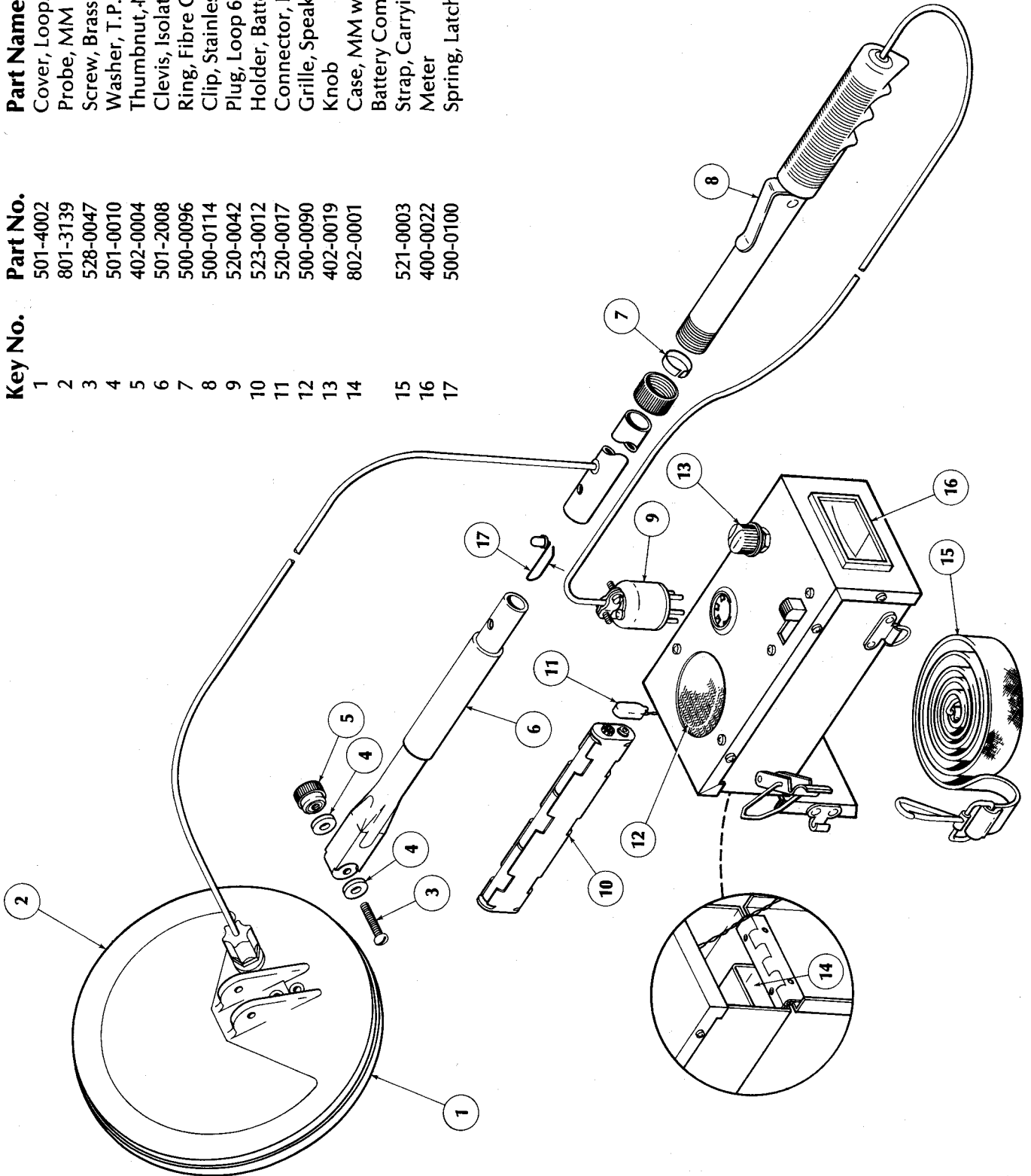



SPORTS CENTER

**MODEL NO.
321.596360**

- assembly
- control description
- trouble shooting
- operating procedures
- maintenance

OWNER'S MANUAL

METAL DETECTOR

TR/Hipmount

When requesting service or replacement parts for your *Sears Metal Detector*, always refer to the serial number plate for the instrument *Model Number*.

All parts listed herein with a part number may be ordered through SEARS, ROEBUCK and CO.

When ordering parts by mail, selling prices will be furnished on request, or parts will be shipped at prevailing prices and you will be billed accordingly.

When ordering parts, always include the following information:

- | | |
|-----------------|--------------|
| 1. Model Number | 3. Part Name |
| 2. Part Number | 4. Quantity |

FULL ONE YEAR WARRANTY

If, within one year from the date of purchase, this metal detector fails due to a defect in materials or workmanship, simply return it to the nearest Sears store throughout the United States and Sears will repair it free of charge.

This warranty gives you specific legal rights, and you may also have other rights which vary from state to state.

SEARS, ROEBUCK and CO.
Sears Tower, BSC 41-3
Chicago, IL 60684